

XPS CAVITY CLOSER INSTALLATION GUIDE

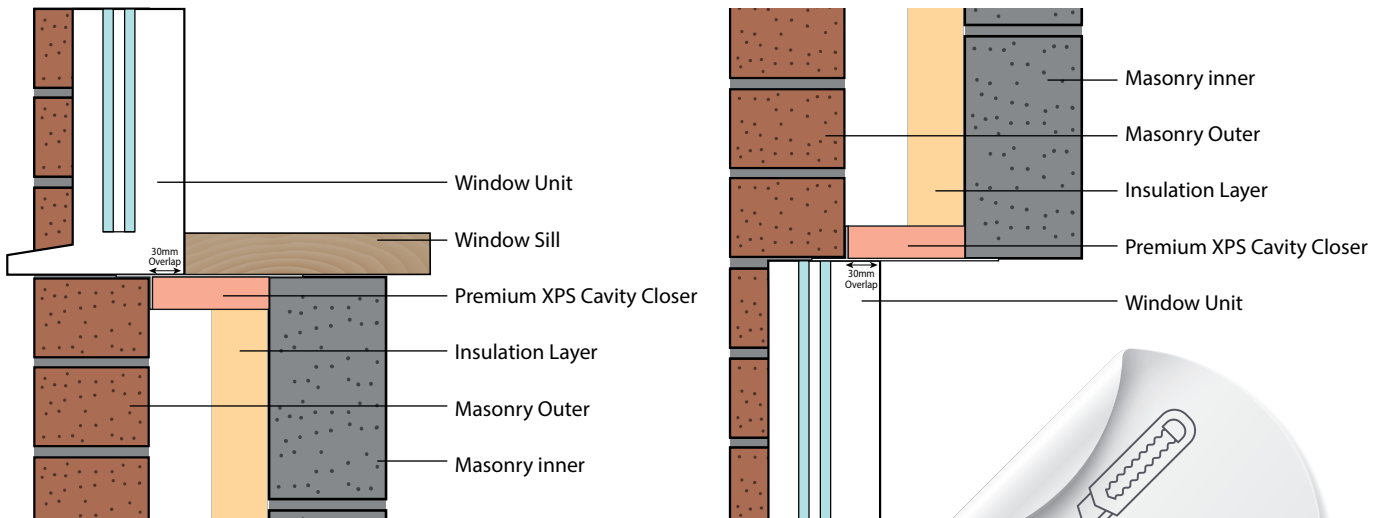

INSTALLATION

Easy-Trim Cavity Closer can be installed in a variety of ways,

- Tack to window frame built in
- Built-in as work progresses friction fitting
- Installed after the reveal has been constructed by fixing to the inner leaf using grab adhesive
- Measure the opening of the window or door.
- Cut profile to required length.
- Measure cavity opening and cut the insulation (do not cut the plastic outer) to the corresponding width. Note, maximum cavity width is 150mm.
- Press the insulation face down into the open cavity opening and fix the plastic outer securely with grab adhesive or clout nails.
- Vertical Jointing - if required, sections can be jointed to minimise waste. All joints must be tightly butted 45° downwards towards the outer leaf, this will stop potential water penetration.
- Corner Jointing - When jointing horizontal to vertical, trim both PVC flanges and allow the vertical to extend below the horizontal this stops water ingress.
- Cutting should be carried out using a fine toothed saw.
- PVC flanges and allow the vertical to extend below the horizontal this stops water ingress.
- Cutting should be carried out using a fine toothed saw.

RELEVANT STANDARDS AND REGULATIONS

- NHBC Technical Requirements 6.7; Doors windows and glazing
- BS 5250 Code of practice for control of condensation in Buildings
- Building Regulations Document Part L1 and L2: conservation of fuel and power in new and existing dwellings